

Customer/Wholesaler:	Date:	Job Name:	Model Specified: 21110	Quantity:
Contractor:		Architect/Engineer:		

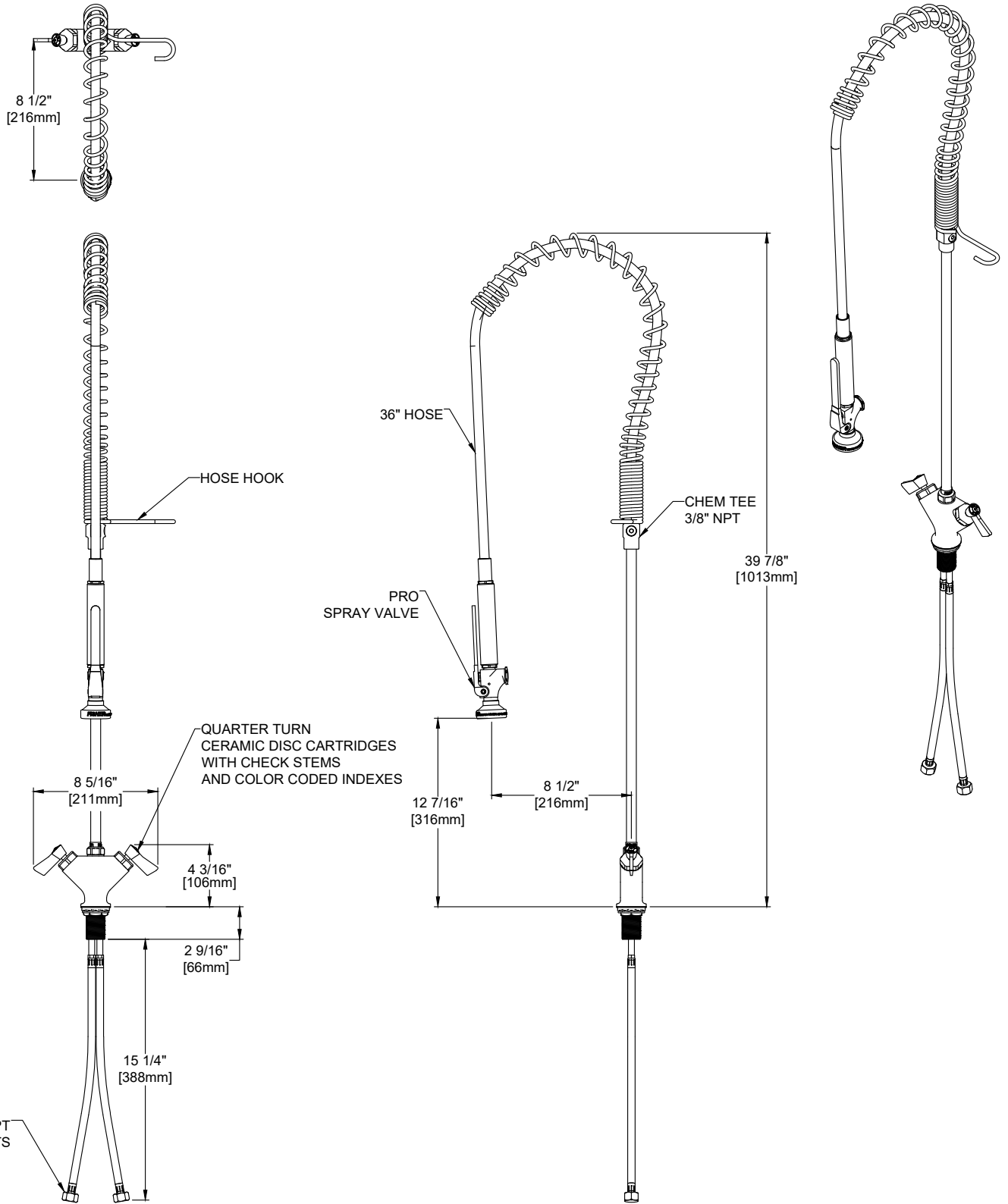

PRODUCT SPECIFICATIONS:
 PRE-RINSE UNIT: SINGLE DECK DUAL CONTROL MOUNT MIXING FAUCET, QUARTER TURN CERAMIC DISC CARTRIDGES W/CHECK STEMS, LEVER HANDLES, 36" FLEXIBLE STAINLESS STEEL HOSE, PRO SPRAY VALVE 2.65 GPM @ 80 PSI, 12" WALL BRACKET, 1/2" NPT FEMALE INLETS

PRODUCT COMPLIANCE:
 ASME A112.18.1 / CSA B125.1
 NSF 61 - Section 9
 NSF 372 (Low Lead Content)

Drawn: LC	Checked: EM	Approved: LC	Date: 02/19/24	Sheet: 1 of 2
-----------	-------------	--------------	----------------	---------------

Customer/Wholesaler:	Date:	Job Name:	Model Specified: 21110	Quantity:
Contractor:		Architect/Engineer:		

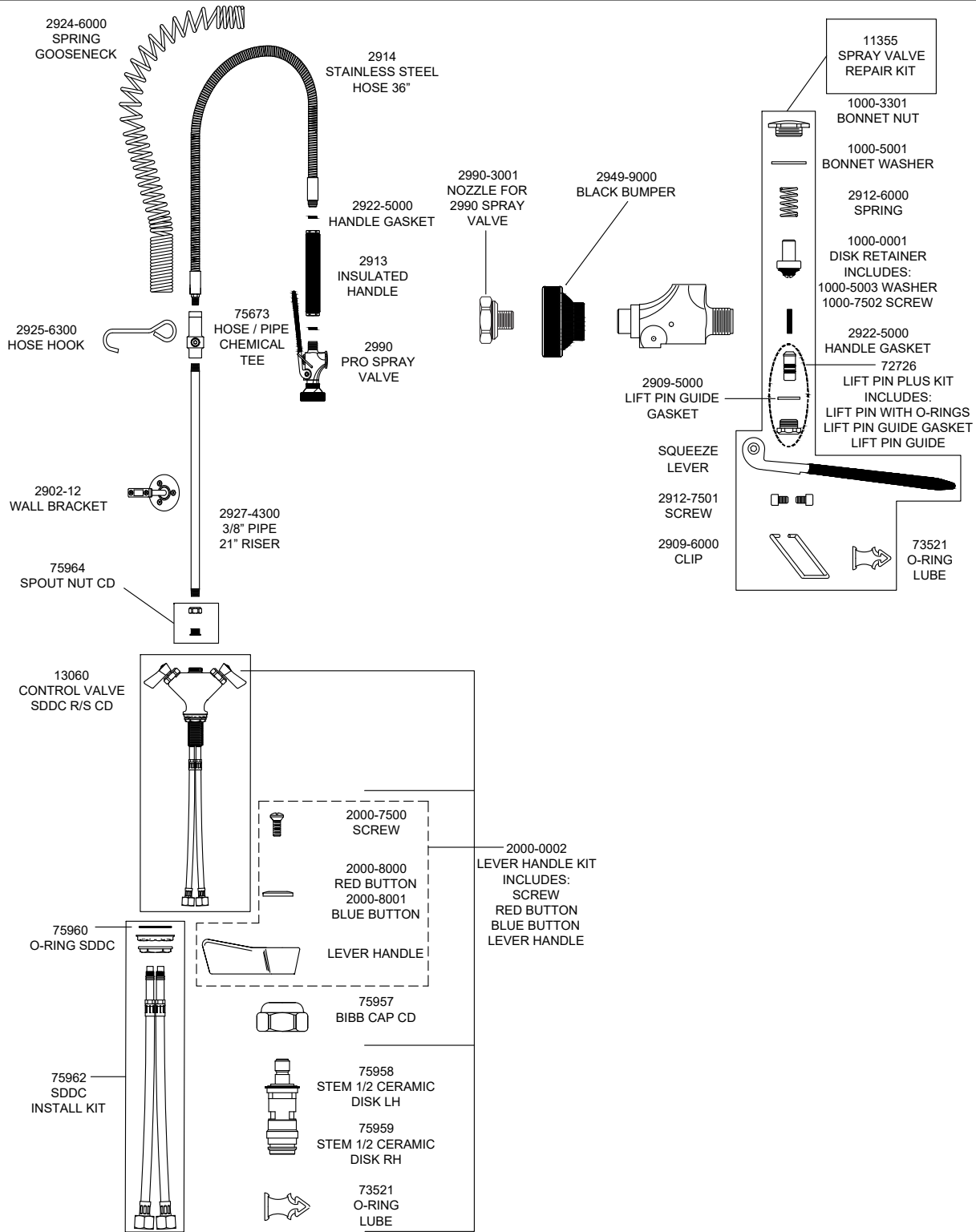

Replacement Parts for Pre-Rinse Units

PRODUCT SPECIFICATIONS:

PRE-RINSE UNIT: SINGLE DECK DUAL CONTROL MOUNT MIXING FAUCET, QUARTER TURN CERAMIC DISC CARTRIDGES W/CHECK STEMS, LEVER HANDLES, 36" FLEXIBLE STAINLESS STEEL HOSE, PRO SPRAY VALVE 2.65 GPM @ 80 PSI, 12" WALL BRACKET, 1/2" NPT FEMALE INLETS

PRODUCT COMPLIANCE:

ASME A112.18.1 / CSA B125.1
NSF 61 - Section 9
NSF 372 (Low Lead Content)